

Adventures with Debbie

**FREE
AIR INCLUDED!**

SEE BACK
FOR DETAILS



Danube Explorer

Hungary • Slovakia • Austria • Germany • the Czech Republic

Departure Date: August 24, 2024

Mayflower
CRUISES & TOURS
A DIVISION OF THE SCENIC GROUP

Danube Explorer



Vienna's Imperial Hofburg Palace



Visit the village Weisenkirchen located in the Wachau Wine Region

DAY 1 Depart the USA: Depart the USA on your overnight flight to Budapest, Hungary.

DAY 2 Budapest, Hungary: Welcome to the 'Pearl of the Danube'. You will be met at the airport and transferred to your Emerald Cruises Star-Ship, home for the next seven nights. This evening, join your fellow guests for a folklore performance onboard and a traditional Hungarian dinner. After dinner, relax on the Sun Deck and enjoy the fabulous view of the city, aglow in nighttime splendor. **Meal: D EmeraldPLUS:** A traditional Hungarian folklore show

DAY 3 Budapest: Explore Budapest's cobbled medieval quarter, as you embark on a coach tour through the UNESCO World Heritage city center. Your guide will highlight a number of architectural wonders and also talk about Budapest's culinary scene. The tour will end at the Grand Market Hall, the city's most expansive indoor food & craft market, where you'll have time to explore on your own. If you are feeling more active, you may instead choose to hike to Buda Hill. The surrounding area has been rebuilt several times, most recently following the air raids of WWII. Some 18th-century Baroque houses still stand, best explored by foot along the medieval paths and alleyways in the area around Buda Castle. **Meals: B, L, D EmeraldACTIVE:** Guided hike to Buda Hill (instead of city tour) **DiscoverMORE*:** Szentendre (additional expense)

*Both DiscoverMORE's operate simultaneously; only one can be selected

DAY 4 Bratislava, Slovakia: This morning, relax onboard while sailing into the capital of Slovakia. This graceful nation became an independent country in 1993, and since then, Bratislava has flourished as a new capital and made a name for itself as a cultural center. The romantic cobblestone lanes that weave through the city are explored with your local guide, as you enjoy a walking tour of the ancient town center, seeing the Slovak National Theater and a range of Gothic and Art Nouveau buildings. For the more active guests, embark on a guided hike to Bratislava Castle, a landmark steeped in legends that looks as though it came from the pages of a fairytale book. **Meals: B, L, D EmeraldACTIVE:** A guided hike to Bratislava Castle (instead of city tour) **EmeraldPLUS:** Local Slovakian entertainment onboard **DiscoverMORE:** Skoda Tour of Post-Communist Bratislava (additional expense)

DAY 5 Vienna, Austria: Welcome to Vienna, Austria's capital and the capital of classical music. The city perfectly encapsulates the opulence of the Habsburg Monarchy and their ornate Baroque palaces. On the included city tour, see monuments and buildings of grandeur as the coach drives along the famous Ringstrasse. During the walking tour, stroll with your guide through the city center, a UNESCO World Heritage Site. Marvel at the classical architectural styles of the buildings, see St. Stephen's Cathedral and the Hofburg Palace, right in the heart of the city center. If you are feeling more active, opt to explore on two wheels, cycling along the river to Danube Island. **Meals: B, L, D EmeraldACTIVE:** Bike tour in Vienna (instead of city tour) **DiscoverMORE:** An exclusive Viennese evening concert with the music of Mozart and Strauss (additional expense)

DAY 6 Weissenkirchen – Melk: Effortlessly suspended in time, Weissenkirchen is one of the most frequented parts of the Wachau wine region, where the delightful warm weather creates the perfect setting for viticulture. Join your Activity Manager for a hike in town before sailing to Melk. Later this morning, sail through the UNESCO World Heritage Wachau Valley, passing medieval villages, terraced vineyards and areas of natural beauty. Upon arrival in Melk, enjoy a guided tour of Melk Abbey, originally a lavish castle that was gifted to Benedictine monks during the 11th century. This opulent Baroque building is home to some of the most important collections of medieval manuscripts in the world. **Meals: B, L, D EmeraldACTIVE:** Hike in Weissenkirchen **EmeraldACTIVE:** A guided bike ride along the Danube **DiscoverMORE:** Weissenkirchen vineyard hike with tasting (additional expense) **DiscoverMORE (from Melk):** Visit to Schallaburg Castle (additional expense)

DAY 7 Linz, Austria / Český Krumlov, Czech Republic: Today's adventure takes you to the UNESCO World Heritage town of Český Krumlov. With its 13th-century castle, meandering river, and a maze of quaint alleyways, this town has one of the best-preserved centers in Europe. Join your local guide to traverse a labyrinth of winding cobblestone lanes as you experience the charming atmosphere of Český Krumlov's medieval buildings and iconic castle complex. During the excursion, visit the 15th-century St. Vitus' Church, a highlight of the town. **Meals: B, D**



Old Town Square, Prague, Czech Republic

EmeraldPLUS: A guided tour of Český Krumlov

DiscoverMORE: Linzer Torte-making workshop (additional expense)

NOTE: The included excursion and DiscoverMORE operate at the same time

DAY 8 Passau, Germany: Narrow cobblestone streets welcome you to Passau, a town nestled on the confluence of three of Europe's main waterways. On today's excursion, venture out to a local farm to gain a fascinating insight into the life of local Bavarian farmers. Tour the farm, see the animals and learn how the family is utilizing methods of sustainable agriculture. Meet with the farmers and sample some of their homemade specialties during an included tasting. **Meals: B, L, D**

EmeraldPLUS: Bavarian farm visit and product tasting

EmeraldACTIVE: Guided hike to Veste Oberhaus (instead of farm visit)

DiscoverMORE: Bavaria Live (additional expense)

DAY 9 Passau – Prague, Czech Republic: After breakfast, say goodbye to your Captain and crew as you disembark your ship and depart by motorcoach for Prague, Czech Republic. Upon arrival, you'll have free time for lunch on your own before the included city tour highlighting the famous sites of this beautiful city. Following a brief panoramic drive, the heart of the city is discovered on foot. See the Old Town Square with its historic astronomical clock, and the medieval Charles Bridge. The tour concludes at the hotel with the evening at leisure. **Meal: B**

DAY 10 Prague: Your final day is left free of planned activities for your independent exploration of Prague. Or, if you choose, join the morning optional excursion to Terezin Concentration Camp. **Meal: B**

DiscoverMORE: Terezin Concentration Camp (additional expense)

DAY 11 Prague / USA: Bid a fond farewell to Europe and return home with wonderful memories of life enriching experiences from your cruise along the Danube River. **Meal: B**

Itinerary is subject to change.

CRUISE AND HOTEL ACCOMMODATIONS

Days 2 through 8 – Aboard an Emerald Cruises Star-Ship

Days 9 and 10 – Hotel Jalta or similar, Prague, Czech Republic

Pre-cruise hotel stays available in Budapest. Call for details.



Exceptional Inclusions

- **21 Meals:** 9 breakfasts, 5 lunches, and 7 dinners
- **Airport transfers** on tour dates when air is provided by Mayflower Cruises & Tours
- Visit **five countries**
- **Seven-night cruise in a suite or stateroom** of your choice onboard the vessel
- **All gratuities included**
- **First-class service** by an English-speaking crew
- **Onboard Activity Manager** will support all EmeraldACTIVE excursions and host daily onboard wellness activities, games, classes and evening entertainment
- **Shore excursions** with English-speaking local guides
- Personal **listening device** for onboard excursions
- Most meals included onboard with a **variety of international cuisine**
- Complimentary **regional wines, beer and soft drinks** accompany onboard lunches and dinners
- Complimentary **bottled water** in your stateroom
- Complimentary **WiFi onboard**
- Complimentary **bicycles onboard** for use ashore
- **All port charges included**
- **Two-night hotel stay and touring** in Prague, the Czech Republic

Emerald Cruises Star-Ships

Built: 2014-20 **Speed:** 15.5 mph **Staterooms:** 19 **Suites:** 72 **Length:** 443 ft. **Crew:** 47

SUN DECK

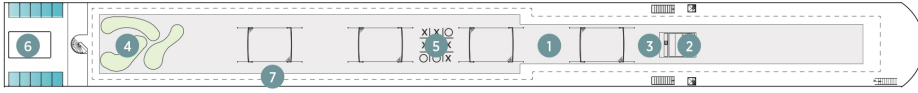

HORIZON DECK

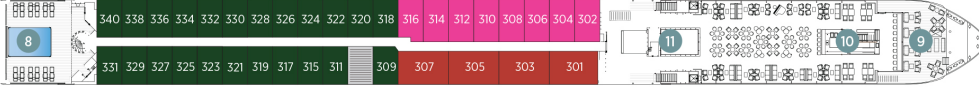

VISTA DECK

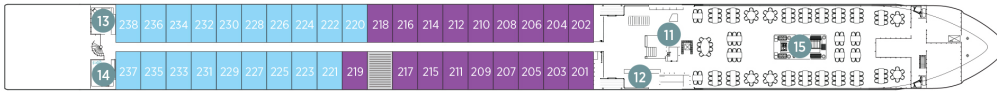

RIVIERA DECK

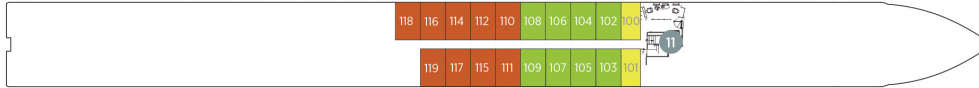

Public Areas and Ship Amenities

- 1 Sun Deck with Deck Chairs
- 2 Navigation Bridge
- 3 Sky Barbeque
- 4 Golf Putting Green
- 5 Games Area
- 6 Retractable Glass Roof
- 7 Walking Track
- 8 Daytime Pool / Evening Cinema
- 9 The Terrace
- 10 Horizon Bar and Lounge
- 11 Elevator
- 12 Reception
- 13 Wellness Area
- 14 Fitness Area
- 15 Reflections Restaurant



Owner's One-Bedroom Suite

315ft²

CAT SA

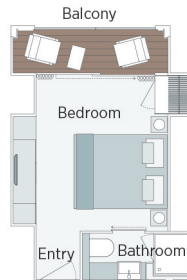

Grand Balcony Suite

210ft²

CAT S



Panorama Balcony Suite

180ft²

CAT A CAT B CAT C

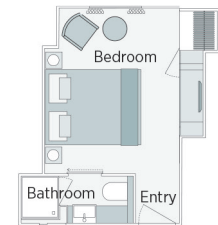

Emerald Stateroom

162ft²

CAT D CAT E

Danube Explorer River Cruise

		August 24, 2024		
CAT	STATEROOM / SUITE	DECK		
			PER PERSON TWIN	
			SINGLE ROOM	
E	Emerald Stateroom	Riviera	\$5,029	+\$3,519
D	Emerald Stateroom	Riviera	\$5,085	+\$3,559
C	Panorama Balcony Suite	Vista	\$5,895	+\$4,129
B	Panorama Balcony Suite	Vista	\$5,949	+\$4,165
A	Panorama Balcony Suite	Horizon	\$6,269	+\$4,389
S	Grand Balcony Suite	Horizon	\$6,925	N/A
SA	Owner's One-Bedroom Suite	Horizon	\$7,465	N/A

Prices Include Roundtrip Air from Nashville, when Booked by August 31, 2023.

(Call for air rates after September 1st)



Travelers Protection Plan (TPP) for River Cruises - \$569 per person

This nonrefundable fee will provide a refund to you during the instance that you have to cancel your trip. The cancellation has to be for a covered reason (see Plan for details on coverage) and we have to be notified at least one day prior to departure. If you must leave the tour early due to personal illness or the illness or death of an immediate family member, TPP will provide a refund for any unused services after the departure of the tour. Other benefits include medical expenses for illness and injury, emergency transportation, 24 hour hot line and lost or stolen baggage assistance. Return air transportation is included ONLY if your air tickets are purchased through Mayflower Cruises & Tours. Please review the Plan for details on coverage. Should you choose not to purchase our TPP, the following per person cancellation charges will be assessed for all tours and optional excursion costs:

- 91 days or more prior to departure: Deposit Amount
- 90 days to day of departure: 100% of total tour
- No refund on unused portions of the tour

Exclusions: Mayflower Cruises & Tours reserves the right to alter its Refund and Cancellation Policy when a substantial amount of cancellation or postponement of travel is attributable to: conditions resulting from an act of God, natural or man-made disaster, fire, government action, civil disorder, war, hostilities between nations, or unavailability of transportation through no fault of Mayflower Cruises & Tours. *Plan and benefits offered and administered by Trip Mate, Inc.*



FOR RESERVATIONS OR INFORMATION CONTACT:

Debbie Laster
731-415-8467

d.laster@charter.net