

Meridian Guided Travel

**FREE
AIRFARE**

WHEN PAID IN FULL
ONE YEAR PRIOR
TO DEPARTURE



Mayflower Cruises & Tours featuring the Emerald Kaia

Safari and The Seychelles

Nairobi to Mahè Island

Departing: January 22, 2027



Safari and The Seychelles

17-Day

Nairobi to Mahé Island

Departing: January 22

Experience East Africa, on an adventurous safari in renowned Kenyan game reserves and parks. Spot some of Africa's 'Big Five' and other iconic wildlife before relaxing on an idyllic cruise through the Indian Ocean and spellbinding Seychelles archipelago.

Praslin Island, Seychelles



① Number of nights — Cruise 📍 Cruise start/finish

Day 1 Depart USA

Depart the USA on your overnight flight to Nairobi, Kenya.

Day 2 Nairobi, Kenya

JAMBO – Welcome to Kenya. Upon arrival at the Jomo Kenyatta International Airport, you will be met and transferred to your hotel in Nairobi, Kenya's colourful capital city. Meet your experienced Driver – Guide at the hotel this evening.

Day 3 Nairobi - Samburu Game Reserve

Your African safari begins this morning as we head north via Nanyuki for the Samburu Game Reserve set in the rugged, semi-arid northern region of Kenya, with spectacular scenic landscape. Your first safari drive is this afternoon. Samburu is visited by large herds of Elephants, drawn by the promise of water. It is one of the best places to find several endemic Northern species, including the reticulated giraffe, the Somali ostrich and Gravy's Zebra. The Samburu culture is a truly fascinating one, sharing a great deal of ancestral and linguistic ties to the Maasai. **Meals: B, L, D**

Day 4 Samburu Game Reserve

Enjoy morning and afternoon game viewing drive. The entire Samburu region is a place of breath-taking and magical beauty, a place where the vision of a deep red sunset silhouetting the doum palms along the river brings the perfect end to a day on safari. Visit a Samburu Manyatta or Village and see what life is like in this harsh landscape. **Meals: B, L, D**

Day 5 Samburu Game Reserve - Lake Nakuru National Park

After breakfast depart for Lake Nakuru National Park with a brief stop at the Thompson's fall for a breath-taking view of the great scenery. The park is one of the best game viewing parks with various animal species including prides of lion, Cape buffalo, waterbucks, warthogs, the endangered Rothschild giraffe, the black & white Rhino, the Burchell's zebra, impala, and the elusive leopard among many others. Over 300 bird species have been recorded here too. Lake Nakuru National Park is one of the best places to see the endangered black and white Rhino. Enjoy an African sunset experience with drinks and canapes. **Meals: B, L, D**

Day 6 Lake Nakuru National Park - Masai Mara Game Reserve

Visit the Mission in Action Orphanage and hear the stories of how it was started by an Australian family. Continue to the Masai Mara National Reserve - Kenya's most renowned game reserve offering wonderful scenery and plenty of wildlife. Arrive at your tented camp for lunch and a little bit of leisure time before you depart on an exciting game viewing drive. The rolling plains and grasslands, stretching far into the horizons as far as the eye can see is home to the black-manned lion, the savannah elephant, the Cape buffalo, wil-debeest, the elusive leopard, cheetah, the spotted & stripped hyena, the rhino, topi, Burchell's zebra, the Maasai giraffe among many others. **Meals: B, L, D**

Day 7 Masai Mara Game Reserve

DiscoverMORE: Optional Hot Air Balloon Safari (extra expense, please book on tour). Enjoy a full day in the Masai Mara with morning and afternoon game drives. Visit a traditional Maasai Village and experience the culture of this world-famous community. The Masai still live as they did for centuries -interact with these nomadic people and experience their way of life as you learn about their customs and traditions. **Meals: B, L, D**

Day 8 Masai Mara Game Reserve

Another day of game drives with an opportunity to see more of the big five that Maasai Mara is famous for. These include the lion, savannah (African) elephant, the Cape buffalo, the leopard and the black rhino. Dine under the stars tonight. **Meals: B, L, D**

Day 9 Masai Mara Game Reserve - Nairobi - Mahé Seychelles

Fly back to Nairobi this morning. This afternoon a visit to the Giraffe Centre followed by the Karen Blixen Museum. Enjoy an early dinner at the Carnivore Restaurant before transferring to the airport for your onward flight to Mahe, The Seychelles. **Meals: B, D**

Day 10 Mahé Island - Sainte Anne Channel

Your tropical cruise begins in Mahé island, where you'll be transferred to your Emerald Cruises luxury yacht and embark on your discovery of the Seychelles. In the afternoon, we sail to Sainte Anne Channel. **Meals: B, D**

Day 11 Sainte Anne Channel - Cousin Island

Sainte Anne Island is encircled by a Marine National Park, home to incredible marine life including more than 150 species of fish. Sainte Anne is now a significant nesting site for Hawksbill turtles. Late morning, we sail to Cousin, a small island renowned as a haven for seabirds. The granitic islet was a pri-vate property until 1968 when it was purchased by the International Council for Bird Preservation to transform it into a nature reserve. It's the most protected island in the archipelago, providing a breeding ground for eleven sea bird species annually and a habitat for five birds native to the Seychelles. We stay overnight in Praslin. **Meals: B, L, D**

Day 12 Praslin Island

Praslin, the second largest island in the Seychelles, is visually stunning with tropical jungle-fringed beaches, emerald waters and powdery sand. Anse Lazio beach has been voted one of the world's best several times and there's a dazzling reef just offshore brimming with coral and marine life. On land, coconut palms and granite boulders create a picture-postcard landscape. In the centre of the island, discover the UNESCO World Heritage-listed Vallée de Mai Nature Reserve. **Meals: B, L, D**

Day 13 La Digue Island - Curieuse Island

Early in the morning, we sail to La Digue Island, the smallest of the three populated islands in the Seychelles. Like Praslin Island, it also possesses world-famous beaches, with one of the most recognisable being Anse Source d'Argent. It has pink-hued sands contrasting with granite boulders and aquamarine waters. We will navi-gate to Curieuse later in the evening. **Meals: B, L, D**

Day 14 Curieuse Island

Curieuse is a rugged island swathed in unspoilt wilderness and home to hundreds of resident Aldabra giant tor-toises. Apart from its obvious natural beauty, it has a fascinating history. It was once a quarantine station, and the original French colonial doctor's house has a museum and visitor's centre. **Meals: B, L, D**

Day 15 Aride Island

Early in the morning, we sail to Aride, a nature reserve in the Indian Ocean. Nature enthusiasts and wildlife pho-tographers flock to this island, where more than thirty rare bird species nest in the verdant vegetation. The landscape is enticing with fine-sand beaches, coconut palms and soaring cliffs. **Meals: B, L, D**

Day 16 Mahé Island

Mahé is the main island of the scenic Seychelles and the largest of the archipelago. It's home to the capital Victoria, which was founded in the French settler period in 1778 and named later by the British, after Queen Victoria. The island of Mahé has pristine beaches dotted with huge rocks and tranquil nature trails threaded through the Morne Seychellois National Park. **Meals: B, L, D**

Day 17 Mahé Island

Your Emerald Cruises voyage concludes here. From the yacht, you will be transferred to the airport for your journey home or to continue your holiday. Please book your flight to depart out of Mahé, Seychelles after 11:00 AM. **Meal: B**

The itinerary is a guide only and may be amended for operational reasons. As such Emerald Cruises cannot guarantee the cruise will operated unaltered from the itinerary states above. Please refer to our terms and condi-tions for further information.

Included in your cruise

- Multiple opportunities to see the
- 'Big Five' (Lion, Elephant, Buffalo, Leopard, and Rhino)
- Three nights in the Masai Mara
- Visit a traditional Maasai Village
- Sundowner drinks at Lake Nakuru
- Discover the Out of Africa story at the Karen Blixen Museum
- Explore eight islands with their spectacular Seychelles landscapes
- The breathtaking Aride nature reserve, inhabited only by island rangers and a breeding site for Indian Ocean seabirds & sea turtles
- Enjoy included EmeraldACTIVE & EmeraldPLUS experiences
- 40 superb meals & complimentary drinks when yacht cruising
- All tips, gratuities & port charges

17-Day Safari and The Seychelles

2027 Departure Date
Journey Code: YX01

JAN 22

			Full Fare Per Person Twin
CAT	Stateroom/Suite	Deck	
D	Oceanview Stateroom	3	\$12,760
B	Balcony Suite	4	\$14,510
Y	Yacht Suite	4	Sold Out
A	Balcony Suite	5	\$14,810
AB	Balcony Suite	6	\$15,110
T	Terrance Suite	6	\$17,860
S	Deluxe Balcony Suite	6	Sold Out
SA	Owner's Suite	6	\$24,760

Free round-trip airfare when paid in full no later than 1 year prior to departure.

Single rate is double the twin rate.

Emerald Raiya

Launching: 2026 Length: 361ft Guests: 128 Suites: 64 Crew Members: 92

Deck 7
Sky Deck

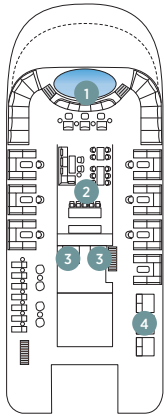

Deck 6
Pool Deck

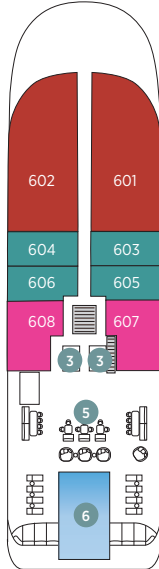

Deck 5
Panorama Deck

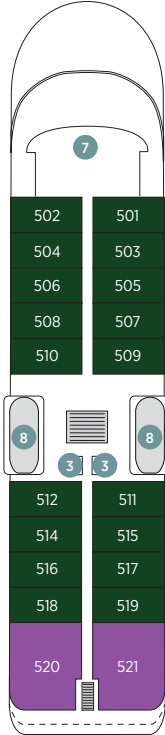

Deck 4
Observation Deck

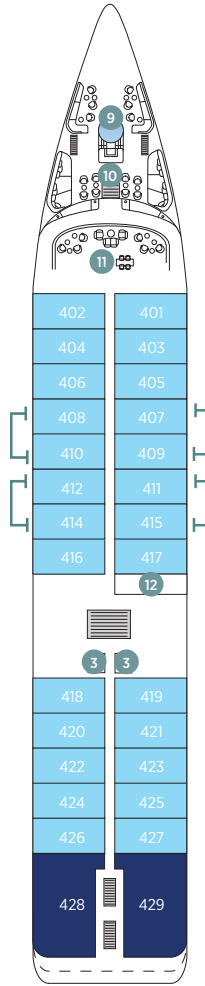

Deck 3
Emerald Deck

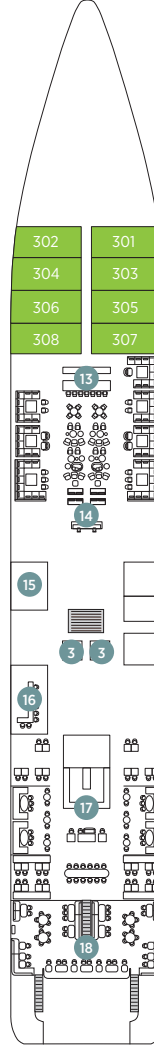

Deck 2
Wellness Deck

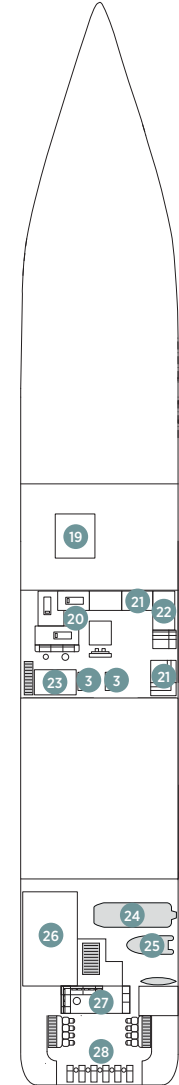

Pool Deck		Size (ft²)
SA	Owner's Suite	1,407ft²
S	Deluxe Balcony Suite	382ft² - 403ft²
AB	Balcony Suite	340ft²
Panorama Deck		Size (ft²)
T	Terrace Suite	830ft²
A	Balcony Suite	340ft²
Observation Deck		Size (ft²)
Y	Yacht Suite	879ft²
B	Balcony Suite	340ft²
Emerald Deck		Size (ft²)
D	Oceanview Stateroom	340ft²

NEW for Emerald Kaia:

Enjoy the luxury of even more generously-sized spaces with larger suites.

Suites 412 & 414, 411 & 415, 408 & 410, 407 & 409 can be booked to create connecting suites.

- 1 Spa Pool
- 2 Sky Bar
- 3 Lifts
- 4 Sky Deck Cabanas
- 5 Aqua Café
- 6 Aqua Pool
- 7 Navigation Bridge
- 8 Life Boats
- 9 Spa Pool
- 10 Observation Sun Deck
- 11 Observation Lounge
- 12 Self-Service Laundry
- 13 Amici Bar & Lounge
- 14 Reception
- 15 Boutique
- 16 Night Market Grill
- 17 La Cucina Dining
- 18 La Cucina Terrace
- 19 Medical Centre
- 20 Elements Spa
- 21 Sauna
- 22 Infrared Sauna
- 23 Hairdresser
- 24 Tender Boat
- 25 Zodiacs
- 26 Gym
- 27 Marina Lounge
- 28 Marina Deck

Travelers Protection Plan (TPP) - \$1,499 per person

This nonrefundable fee will provide a refund to you during the instance that you have to cancel your trip. The cancellation has to be for a covered reason (see Plan for details on coverage) and we have to be notified at least one day prior to departure. If you must leave the tour early due to personal illness or the illness or death of an immediate family member, TPP will provide a refund for any unused services after the departure of the tour. Other benefits include medical expenses for illness and injury, emergency transportation, 24 hour hot line and lost or stolen baggage assistance. Return air transportation is included ONLY if your air tickets are purchased through Mayflower Cruises & Tours. Please review the Plan for details on coverage.

Should you choose not to purchase our TPP, the following per person cancellation charges will be assessed for all tours and optional excursion costs:

- 121 days or more prior to departure: Deposit Amount
- 120 days until day of departure: 100% of total tour
- No refund on unused portions of the tour

Exclusions for the Cancellation Fee Waiver: Mayflower Cruises & Tours reserves the right to alter its Refund and Cancellation Policy when a substantial amount of cancellation or postponement of travel is attributable to: conditions resulting from an act of God, natural or man-made disaster, fire, government action, civil disorder, war, hostilities between nations, or unavailability of transportation through no fault of Mayflower Cruises & Tours.

Air itineraries may not be available until documents are received. Air seats are assigned by the airline for the entire group and may not be available until airport check-in. Seat changes can only be attempted at the airport and may not be possible. If specific seat assignments are vital to your reservation, we recommend booking air on your own rather than booking air with the group.



Passport & Visas - Each U.S. citizen must have a valid passport. Expiry date of passports should be at least 6 months after the return date of tour. If you don't have a passport, call our office and we'll tell you how to apply for one. Some countries require visas for entry by U.S. citizens. We will send visa applications and instructions if a visa is required for your tour. Holders of non-U.S. passports should contact their nearest consulate and inquire about the necessary passport or visa documentation required for entry into the countries visited. NOTE: Due to airline security measures, your passport name must match your airline ticket name and your tour reservation name or you may be denied aircraft boarding.

FOR RESERVATIONS OR INFORMATION CONTACT:

Matt Maturo
(714) 718-8520

or

mattm@meridianguidedtravel.com

