

CROPPIN' BUG TRAVELERS

**FREE
AIRFARE**
+\$300 PER
PERSON
SAVINGS
SEE BACK FOR
DETAILS



10 DAYS • 20 MEALS • AMSTERDAM > AMSTERDAM

HOLLAND & BELGIUM IN BLOOM

Departure Date: April 14, 2027

Sail through the heart of the Netherlands and Belgium on this captivating Emerald Cruises journey.

From Amsterdam's charming canals to the colorful tulip fields of Keukenhof, experience iconic Dutch beauty and culture. Discover the historic windmills of Zaanse Schans, the artistic treasures of The Hague, and Antwerp's medieval splendor. Enjoy exclusive experiences like clog painting, guided bike tours, and private museum visits—all while relaxing aboard your luxurious Star-Ship, where comfort, cuisine, and culture flow seamlessly together.

Mayflower
CRUISES & TOURS
A DIVISION OF THE SCENIC GROUP



DAY 1 Depart the USA

Depart the USA on your overnight flight to Amsterdam, the Netherlands.

DAY 2 Amsterdam, the Netherlands

Welcome to Amsterdam, where you'll be greeted by one of our Emerald Cruises representatives and transferred to your hotel. You are welcome to relax in the hotel or if you prefer you may want to go and explore Amsterdam with its picturesque canals, world-class museums, theaters, and cafés.

DAY 3 Amsterdam, the Netherlands

After checking out of the hotel this morning, transfer to your Emerald Cruises Star-Ship, home for the next seven nights. Meals: B, D

DAY 4 Amsterdam – Zaanse Schans

This morning, you will have the opportunity to visit one of Holland's main attractions as you venture to Zaanse Schans. Historic windmills,



distinctive wooden houses, and artisan workshops make up this quintessentially Dutch town, where the smell of freshly baked goods and the sight of spinning windmills offers a truly memorable experience. Alternatively, enjoy a guided bike tour to Waterland, passing picturesque scenery and iconic fields of tulips. Relax on board your Star-Ship this afternoon, as we welcome a local clog painter on board for a demonstration. As part of our EmeraldPLUS program, you'll have the opportunity to try your hand at this unique craft. Meals: B, L, D

DAY 5 Rotterdam (The Hague) – Willemstad

Today, you will have an exclusive visit to the beautiful Mauritshuis museum, home to the best of Dutch painting from the age of Rembrandt and Vermeer – and specially known for being the home of the "Girl with the pearl earring". In the afternoon, those feeling more active can enjoy a guided bike tour through the Dutch countryside. Meals: B, L, D

DAY 6 Rotterdam

Rotterdam is a unique example of a Dutch city. Following the air raids of WWII, reconstruction efforts utilised a patchwork of architectural styles, forever altering the skyline. Today, you'll have the opportunity to explore this contemporary city, which currently boasts the tallest commercial and residential buildings in the Netherlands. The reputation as the city of high rises has historical roots, beginning with the construction of the 45-metre-high office building, the Witte Huis, which, for quite some time, was the tallest office building in Europe. Meals: B, L, D

DAY 7 Antwerp

This morning, you'll arrive in Belgium's largest port Antwerp. Located on the River Scheldt, the city's large harbour provides a link to the sea. Home to the famous Baroque artist Pieter Paul Rubens, Antwerp attracts art-lovers from all over the world. Enjoy a guided tour of the city centre, with its café-lined cobble lanes. Admire the Renaissance city hall and Hat Steen, a medieval fortress that was built during the early



Visit Keukenhof Gardens

Middle Ages and one of the oldest build-ings in Belgium. Afterwards, enjoy free time to explore Antwerp at your leisure. *Meals: B, L, D*

DAY 8 Nijmegen

Welcome to Nijmegen, the Roman settlement of Noviomagus and the oldest town in the Netherlands. Join a walking tour through its centre, exploring its architectural wonders and learn more about the International Four Days Marches Nijmegen that takes place every year, welcoming tens of thousands of people. If you are feeling more active, join a bike ride along the river, embracing the unique countryside features along the Waal river. *Meals: B, L, D*

DAY 9 Amsterdam

Experience traditional Holland today during a visit to the beloved Keukenhof Gardens. Nestled in the middle of the region's tulip farms, where row-upon-row of technicolour flowers stretch as far as the eye can see, the gardens boast incredible displays of millions of bulb varieties, all perfectly assembled by an expert landscape architect. *Meals: B, L, D*



Nijmegen, Netherlands



EXCEPTIONAL INCLUSIONS

- 21 Meals: 8 breakfasts, 6 lunches and 7 dinners
- Airport transfers on tour dates when air is provided by Mayflower Cruises & Tours
- Seven-nights in a suite or stateroom of your choice onboard the vessel
- First-class service by an English-speaking crew
- Onboard Activity Manager will support all EmeraldACTIVE excursions and host daily onboard wellness activities, games, classes and evening entertainment
- All gratuities included
- Shore excursions with English-speaking local guides
- Visit UNESCO World Heritage Sites
- Personal listening device for shore excursions
- All meals included onboard
- Variety of international cuisine
- Complimentary regional wines, beer and soft drinks with onboard lunches and dinners
- Complimentary bottled water in your stateroom
- Complimentary WiFi onboard
- Complimentary bicycles onboard for use ashore
- All port charges included

DAY 10 Amsterdam

After breakfast, it's time to bid farewell to your fellow guests as you disembark your Star-Ship for your transfer to the airport, taking memories of wooden windmills and blossoming flowers with you. *Meal: B*

Itinerary and excursions are subject to change.

Additional excursions will be released approximately 180 days prior to departure.

HOTEL AND CRUISE ACCOMMODATIONS

Day 2 – Hotel TBA, Amsterdam, the Netherlands

Days 3 through 9 – Aboard an Emerald Cruises Star-Ship

EMERALD STAR-SHIPS

Built: 2014-2026 Cabins: 91 Guests: 180 Length: 443 ft. Crew: 52



- 1 Sun Deck with Deck Chairs*
- 2 Navigation Bridge
- 3 Sky Barbecue
- 4 Golf Putting Green
- 5 Games Area
- 6 Retractable Glass Roof
- 7 Walking Track
- 8 Daytime Pool & Bar/Evening Cinema
- 9 The Terrace
- 10 Horizon Bar & Lounge
- 11 Lift
- 12 Reception
- 13 Wellness Area
- 14 Fitness Area
- 15 Reflections Restaurant

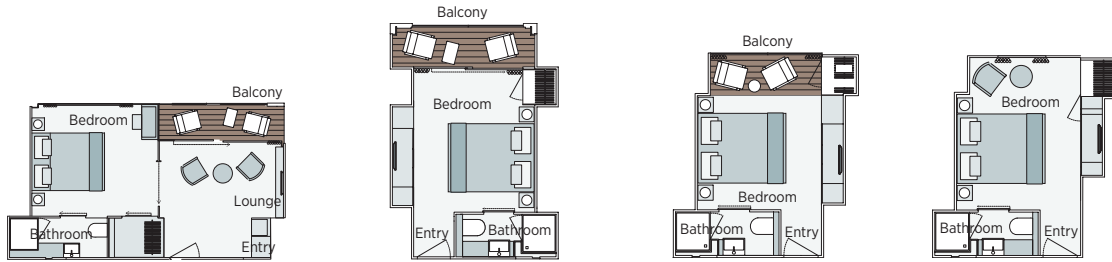

Owner's One-Bedroom Suite
285ft² – 315ft²

CAT SA

Grand Balcony Suite
207ft² – 210ft²

CAT S

Emerald Panorama Balcony Suite
160ft² – 189ft²

CAT A CAT B CAT C

Emerald Stateroom
153ft² – 170ft²

CAT D CAT E

Important Information: The cabin and deck plans, sizes and photographs are an indication only and are subject to variation. * Due to safety, the Sun Deck will be closed when travelling under low bridges.

Tour Code EWTU 2027 Departure Date	RIVIERA DECK		VISTA DECK		HORIZON DECK		HORIZON DECK		HORIZON DECK	
	CAT E, D		CAT C, B		CAT A		CAT S		CAT SA	
	PER PERSON TWIN	SINGLE ROOM	PER PERSON TWIN	SINGLE ROOM	PER PERSON TWIN	SINGLE ROOM	PER PERSON TWIN	SINGLE ROOM	PER PERSON TWIN	SINGLE ROOM
April 14	\$5,064	+ \$4,810	\$6,039	+ \$5,785	\$6,289	+ \$6,035	\$7,289	N/A	\$8,389	N/A

Free roundtrip airfare when reservation is made by January 31, 2026!

Save \$300 per person when reservation is made December 31, 2025!

Pricing includes pre-night hotel stay in Amsterdam, and roundtrip airport transfers to IAH.

After January 31, 2026, phone for airfare rate.

Air itineraries may not be available until documents are received. Air seats are assigned by the airline for the entire group and may not be available until airport check-in. Seat changes can only be attempted at the airport and may not be possible. If specific seat assignments are vital to your reservation, we recommend booking air on your own rather than booking air with the group.



Travelers Protection Plan (TPP) for River Cruises – \$569 per person (optional)

This nonrefundable fee will provide a refund to you during the instance that you have to cancel your trip. The cancellation has to be for a covered reason (see Plan for details on coverage) and we have to be notified at least one day prior to departure. If you must leave the tour early due to personal illness or the illness or death of an immediate family member, TPP will provide a refund for any unused services after the departure of the tour. Other benefits include medical expenses for illness and injury, emergency transportation, 24 hour hot line and lost or stolen baggage assistance. Return air transportation is included ONLY if your air tickets are purchased through Mayflower Cruises & Tours. Please review the Plan for details on coverage. Should you choose not to purchase our TPP, the following per person cancellation charges will be assessed for all tours and optional excursion costs:

- 121 days or more prior to departure: Deposit Amount
- 120 days to day of departure: 100% of total tour
- No refund on unused portions of the tour

Exclusions: Mayflower Cruises & Tours reserves the right to alter its Refund and Cancellation Policy when a substantial amount of cancellation or postponement of travel is attributable to: conditions resulting from an act of God, natural or man-made disaster, fire, government action, civil disorder, war, hostilities between nations, or unavailability of transportation through no fault of Mayflower Cruises & Tours. Plan and benefits offered and administered by Trip Mate, Inc.

FOR RESERVATIONS OR INFORMATION CONTACT:

Neva Young
409-599-9384
croppinbugtxcty@aol.com

