

TEXAN TRIPPERS

FREE
AIRFARE
+\$200 PER
PERSON
SAVINGS

SEE BACK FOR DETAILS



13 DAYS • 25 MEALS • GENEVA > AMSTERDAM

JEWELS OF THE RHINE & GOLDEN PASS RAIL JOURNEY

Switzerland • France • Germany • the Netherlands

Departure Date: June 6, 2027

Begin your vacation with four nights in Lausanne, Switzerland, exploring its stunning surroundings. Ride the Golden Pass train through the Swiss Alps from Montreux to Gstaad before boarding your luxurious cruise ship in Basel. Sail the romantic Rhine through four countries, discovering castles, vineyards, and colorful towns on included excursions. This unforgettable rail and river journey promises lasting memories.

Mayflower
CRUISES & TOURS
A DIVISION OF THE SCENIC GROUP



DAY 1 Depart the USA

Depart the USA on your overnight flight to Geneva, Switzerland.

DAY 2 Geneva – Lausanne, Switzerland

Welcome to Switzerland! You will be met at the airport and transferred by coach to the beautiful city of Lausanne. Flights should arrive by 3:00pm. The remainder of the day is at leisure to begin exploring your new surroundings. Enjoy an included dinner this evening at the hotel.

Meal: D

DAY 3 Lausanne

Begin the day with a panoramic tour of the city, known around the world for its spectacular setting, and home of the International Olympic Committee and Museum. This afternoon, visit Château de Chillon, one of Europe's best-preserved medieval castles, on the shores of Lake Geneva. Surrounded by breathtaking scenery, discover the history of this 13th-century fortress. Learn about the château's association with famous authors and artists; the counts and dukes who inhabited it as well as the prisoners who occupied the jail; see period furnishings, art treasures and frescoes. The beauty of the area continues to amaze during a cruise on Lake Geneva from the harbor in Montreux. Relax onboard as the spectacular scenery unfolds while sailing back to Lausanne before returning to the hotel. Meal: B

DAY 4 Lausanne / Golden Pass

Today may be a highlight of your time in Switzerland as you experience a unique rail journey and mountain adventure. Depart by coach to Montreux where it's 'all aboard' the Golden Pass for an unforgettable panoramic train ride through the scenic landscapes of the Alps. Disembark the train in Gstaad where the coach is waiting to take you to Col du Pillon for the Glacier 3000 mountain adventure. Ascend via arial cable car to an altitude of approximately 9850' above sea level where you are met with astounding panoramic views, including the Matterhorn and Jungfrau. Walk across the world's first suspension bridge connecting two mountain summits, if you dare! Return to the hotel in Lausanne this afternoon. Meals: B, D

DAY 5 Lausanne

The day is left free of planned activities for your independent exploration. If you prefer, join an optional excursion to visit the village of Gruyère (famous for cheese-making) and Maison Cailler Chocolate Factory. Meal: B

DAY 6 Lausanne – Huningue, France

After breakfast, depart Lausanne and travel by coach to Huningue for embarkation of the Emerald Cruises Star-Ship and start of the cruise along the Rhine River. Settle into your stateroom and enjoy your first meal onboard at dinner this evening. Meals: B, D

DAY 7 Breisach, Germany

As part of the EmeraldPLUS program, visit the city of Freiburg. Considered the 'capital of the Black Forest', Freiburg has lovely sights that will leave you amazed. You also have the opportunity to sample true Black Forest delicacies from the lively market in the city center near the main cathedral. If you're feeling more active, join the guided bike tour in Breisach. Enjoy local entertainment onboard this evening. Meals: B, L, D

DAY 8 Kehl / Strasbourg, France

Arrive in Strasbourg, the capital city of the Alsace Region in France. The guided walking tour takes you along narrow lanes and across footbridges as you discover the Grande Île, the historical city center and UNESCO World Heritage Site. Known for its medieval black and white timber-framed buildings, picturesque le Petite France, old tanning houses, canals and river locks, the city's star attraction is the ornate cathedral, dominating the main square. This afternoon, the city is yours to explore at leisure. Meals: B, L, D

DAY 9 Mannheim / Heidelberg, Germany

Relax onboard as the vessel cruises along the Rhine River to Mannheim, docking site for Heidelberg. Travel by coach to Heidelberg, home of the oldest university in Germany. The guided walking tour visits the ruins of Heidelberg Castle, with fantastic



Strasbourg, France

views overlooking the Neckar River, and takes you through the cobblestoned-streets of the medieval city below. Alternatively, hike from Mount Königstuhl to Heidelberg. Local entertainment is provided onboard this evening. **Meals: B, L, D**

DAY 10 Koblenz

Begin the day sailing through the spectacular UNESCO World Heritage Rhine Gorge. Pass countless medieval castles and vineyards lining the shores of this section of the river, with photo opportunities around every bend. See the infamous Lorelei statue and Pfalzgrafenstein Castle, built on an island in the middle of the river as a medieval toll station. Continue cruising to the 2000-year-old town of Koblenz, situated at the confluence of the Rhine and Moselle Rivers. Enjoy a walking tour through the streets of the city as your guide points out historic monuments and buildings. See the 'German Corner' monument marking the confluence of the Rhine and Moselle Rivers. This evening, attend a private concert as part of the EmeraldPLUS program. **Meals: B, L, D**

DAY 11 Cologne > Düsseldorf

This morning, you'll will arrive in Cologne and have the chance to know one of Germany's oldest cities and get up close with the famous post card worthy Cathedral. After lunch, join a walking tour of Düsseldorf, a vibrant city renowned for its stylish boutiques and charming Old Town. Stroll along the picturesque Rhine River, admire the stunning architecture and discover hidden gems off-the-beaten path. Immerse yourself in the city's lively atmosphere, indulge in the delicious local cuisine, and marvel at the contrast of Düsseldorf's ancient and modern charms. **Meals: B, L, D**

DAY 12 Zaandam / Amsterdam, the Netherlands

This morning, discover the charm of Alkmaar, a picturesque Dutch town just a short distance from Amsterdam. Explore its historic center, lined with charming canals and medieval buildings. Alkmaar is famous for its centuries-old cheese market where traditional cheesemakers showcase their craft and engage in lively auctions. Immerse yourself in the local culture in this typical charming town. **Meals: B, L, D**

DAY 13 Zaandam / Amsterdam / USA

Bid 'auf wiedersehen' to Europe and return home with memories of life-enriching experiences from your European adventure and cruise along the Rhine River. **Meal: B**

Itinerary and excursions are subject to change.

Additional excursions will be released approximately 180 days prior to departure.



EXCEPTIONAL INCLUSIONS

- 25 Meals: 11 breakfasts, 6 lunches and 8 dinners
- Airport transfers on tour dates when air is provided by Mayflower Cruises & Tours
- Visit four countries
- Four-night hotel stay and touring in Lausanne
- Visit to Château de Chillon on Lake Geneva
- Cruise on Lake Geneva
- Scenic journey aboard the Golden Pass Railway
- Glacier 3000 Mountain Adventure
- Seven-nights in a suite or stateroom of your choice onboard the vessel
- First-class service by an English-speaking crew
- Onboard Activity Manager will support all EmeraldACTIVE excursions and host daily onboard wellness activities, games, classes and evening entertainment
- All gratuities included
- Shore excursions with English-speaking local guides
- Personal listening device for shore excursions
- Visit UNESCO World Heritage Sites
- All meals included onboard with a variety of international cuisine
- Complimentary regional wines, beer and soft drinks with onboard lunches and dinners
- Complimentary bottled water in your stateroom
- Complimentary WiFi onboard
- Complimentary bicycles onboard for use ashore
- All port charges included

CRUISE AND HOTEL ACCOMMODATIONS

Days 2 through 5 – Movenpick Hotel or similar, Lausanne, Switzerland

Days 6 through 12 – Aboard an Emerald Cruises Star-Ship

Post-cruise hotel stays available in Amsterdam. Call for details.

EMERALD STAR-SHIPS

Built: 2014-2026 Cabins: 91 Guests: 180 Length: 443 ft. Crew: 52



- 1 Sun Deck with Deck Chairs*
- 2 Navigation Bridge
- 3 Sky Barbecue
- 4 Golf Putting Green
- 5 Games Area
- 6 Retractable Glass Roof
- 7 Walking Track
- 8 Daytime Pool & Bar/Evening Cinema
- 9 The Terrace
- 10 Horizon Bar & Lounge
- 11 Lift
- 12 Reception
- 13 Wellness Area
- 14 Fitness Area
- 15 Reflections Restaurant

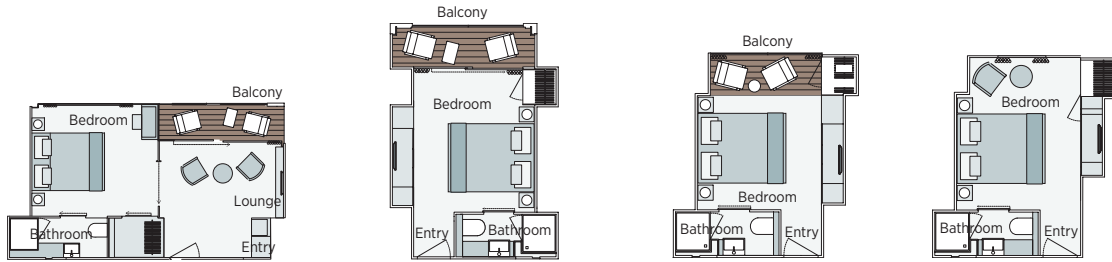

Owner's One-Bedroom Suite
285ft² – 315ft²

CAT SA

Grand Balcony Suite
207ft² – 210ft²

CAT S

Emerald Panorama Balcony Suite
160ft² – 189ft²

CAT A CAT B CAT C

Emerald Stateroom
153ft² – 170ft²

CAT D CAT E

Important Information: The cabin and deck plans, sizes and photographs are an indication only and are subject to variation. * Due to safety, the Sun Deck will be closed when travelling under low bridges.

Tour Code 802GE 2027 Departure Date	RIVIERA DECK		VISTA DECK		HORIZON DECK					
	CAT E, D Emerald Stateroom		CAT C, B Panorama Balcony Suite		CAT A Panorama Balcony Suite		CAT S Grand Balcony Suite		CAT SA Owner's One-Bedroom Suite	
	PER PERSON TWIN	SINGLE ROOM	PER PERSON TWIN	SINGLE ROOM	PER PERSON TWIN	SINGLE ROOM	PER PERSON TWIN	SINGLE ROOM	PER PERSON TWIN	SINGLE ROOM
June 6	\$6,880	+ \$5,160	\$7,963	+ \$5,972	\$8,220	+ \$6,165	\$8,999	N/A	\$9,865	N/A

Free roundtrip airfare from Dallas-Fort Worth, TX when reservations are made by June 1st, 2026.
Book by March 31st, 2026 and receive \$200 off per person.
 After June 1st, phone for current airfare rate.

Air itineraries may not be available until documents are received. Air seats are assigned by the airline for the entire group and may not be available until airport check-in. Seat changes can only be attempted at the airport and may not be possible. If specific seat assignments are vital to your reservation, we recommend booking air on your own rather than booking air with the group.



Travelers Protection Plan (TPP) for River Cruises –\$569 per person (optional)

This nonrefundable fee will provide a refund to you during the instance that you have to cancel your trip. The cancellation has to be for a covered reason (see Plan for details on coverage) and we have to be notified at least one day prior to departure. If you must leave the tour early due to personal illness or the illness or death of an immediate family member, TPP will provide a refund for any unused services after the departure of the tour. Other benefits include medical expenses for illness and injury, emergency transportation, 24 hour hot line and lost or stolen baggage assistance. Return air transportation is included ONLY if your air tickets are purchased through Mayflower Cruises & Tours. Please review the Plan for details on coverage. Should you choose not to purchase our TPP, the following per person cancellation charges will be assessed for all tours and optional excursion costs:

- 121 days or more prior to departure: Deposit Amount
- 120 days to day of departure: 100% of total tour
- No refund on unused portions of the tour

Exclusions: Mayflower Cruises & Tours reserves the right to alter its Refund and Cancellation Policy when a substantial amount of cancellation or postponement of travel is attributable to: conditions resulting from an act of God, natural or man-made disaster, fire, government action, civil disorder, war, hostilities between nations, or unavailability of transportation through no fault of Mayflower Cruises & Tours. Plan and benefits offered and administered by Trip Mate, Inc.

FOR RESERVATIONS OR INFORMATION CONTACT:

Andrea Maltz

Associate of Lynn Schafer

405-830-0935

a.maltz@cruiseplanners.com

andreamaltz.daydreamertraveler.com

